

Specification Sheet No

PSA  
195

Description

GRADUS CHR110  
COMBINATION RAIL

Date

AUG  
2023

## ARCHITECTURAL SPECIFICATION / BOQ

### SPECIFICATION:

Supply and install CHR110 Combination Rail modular system comprising an aluminium retainer, PVC-u cover and PVC-u accessories including returns, inside and outside corners and brackets, with easy-to-clean PVC-u covers and accessories which are through-coloured and textured to conceal the effects of impact and abrasion and can be replaced in the event of damage caused by impact, with accessories featuring closed slots to ensure they remain in place in the event of impact and are supplied with black reveals in an antibacterial finish to provide neat, smooth joints, comprising a handrail element featuring a 38mm diameter and incorporating a thumb groove to offer a comfortable grip in line with guidance, whilst the PVC-u covers and accessories are available in 32 colour options to allow visual contrast to be achieved (note: the CHR1103 mounting bracket is supplied in the colour 002 Gravel only), supplied in 4.00m lengths

Colour:

Code:

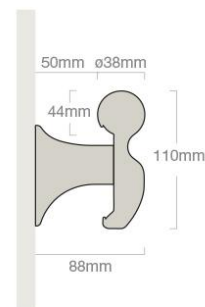
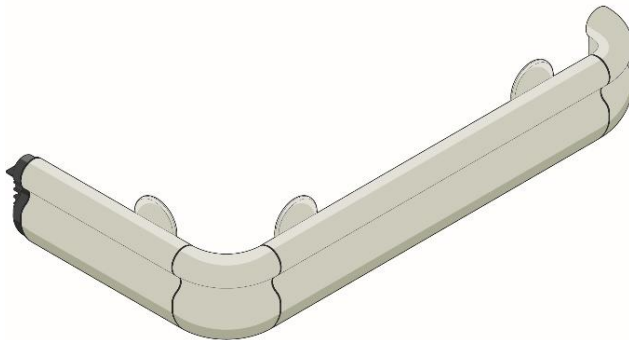

## SPECIALIST FLOORING & WALL PROTECTION PARTNER

Tel: 011 609 3500 | Email: [marketing@polyflor.co.za](mailto:marketing@polyflor.co.za) | [www.polyflor.co.za](http://www.polyflor.co.za)  
Poly Sales House, 8B Buwbes Road North, Sebenza, 1609, South Africa. PO Box 3967, Edenvale, 1610, South Africa

Poly Sales Africa (Pty) Ltd. trading as Polyflor South Africa. Company Registration 2004/012256/07

## INSTALLATION:

### Preambles:

A mock-up room is recommended prior to commencement of the project to ensure profiles are installed according to Polyflor installation guidelines.

Material must be installed in environmentally controlled conditions.

Identify your substrate (cement, brick, drywall as there are different installation methods and materials for each.

Identify the paint applied to your substrate as this may impact on the adhesive to be used.

1. Cut the aluminium retainer to the desired length, leaving appropriate allowance for return, outside corners and inside corners. Allow 83mm for each return, 7mm for each outside corner and 119mm for each inside corner.
2. Drill holes in the centerline of the aluminium retainer for brackets, using an 8mm drill bit. Holes should be 102mm from the ends and spaced every 650mm. Also, holes should be drilled 10mm from each end of the aluminium retainer using an 8mm drill bit to attach returns or corners. *On a short wall, allow at least two extra brackets.*
3. Position the aluminium retainer against the wall at the desired height, allowing for returns, outside corners or inside corners. Level the retainer and transfer the locations of the bracket holes to the wall with a marker. Do not transfer holes for the returns. Drill all marked holes on the wall with a drill bit suitable for the fixings being used.
4. Attach returns and corners to the aluminium retainer using one 6.5mm x 25mm hex bolt, two 6.5mm flat washers, one 6.5mm lock washer, and one 6.5mm hex nut for each return. To allow for adjustment, leave at least a 6.5mm gap between the returns/corners and the end of the aluminium retainer when sliding the two components together. Attach the brackets loosely to the aluminium retainer with the provided hardware one 125mm hex head screw, one lock washer and one toggle wing or lead anchor. For dry walls: Mount the assembled retainer and brackets into the holes on the wall. Level retainer and tighten the screws to secure retainer to the wall. A 125 mm long screw with PVC plug can be used for cement/brick walls. Use a flat washer on the screw before inserting.
5. Cut the vinyl cover to the distance between the returns and/or corners. Position the vinyl cover on the aluminium retainer to check the fit. Adjust returns/corners on the aluminium retainer to obtain a tight fit with the vinyl cover. Attach the vinyl cover to the retainer, starting at the top and pivoting it over the bottom of the retainer until it snaps into place.

## MAINTENANCE:

A regular scheduled maintenance programme should be employed to prevent the build-up of dirt and grease, which will detract from the overall appearance of the product and can lead to the spread of germs and bacteria.

Apply a neutral cleaner to a micro fibre cloth and wipe the surface of the profile. When cleaning handrails, particular attention should be paid to the underside of the handrail as this is where dirt and grease can build up.

The cleaned surface should then be 'rinse wiped' using clean water and then thoroughly dried using a soft cloth. This ensures all cleaning residue is removed.

**Abrasive cleaners, solvents, or cleaning pads (e.g., Thinners, Turpentine, Handy Andy) should NOT be used as they will damage the profile surface.**