

# SHR40P Handrail

## Features

- > Handrails are designed to offer pedestrian guidance and support in addition to a level of surface protection
- > Aluminium retainer with PVC-u covers and matching PVC-u accessories
- > Suitable for use in a wide range of environments including healthcare, education and transport
- > Reveals provide tight, neat joints and are made from a naturally bactericidal polymer that inhibits the growth of bacteria

## Information

- > Supplied in 4.0m lengths
- > Accessories include reveal(s)
- > Replacement components available to purchase
- > Handrails feature a smooth finish in line with HBN 00-04
- > All options are designed to meet guidelines in HBN 00-10, HBN 00-04, BS 8300-2:2018 and Approved Documents K and M of The Building Regulations 2010
- > 32 colour options see page 42

## Components

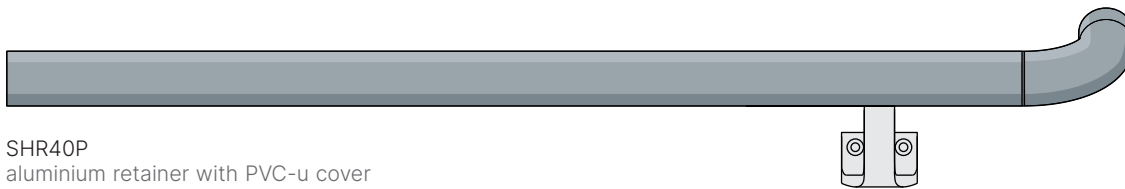

SHR40P  
aluminium retainer with PVC-u cover

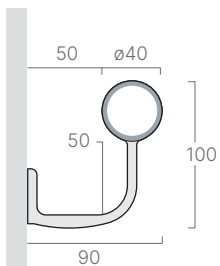

SHR403  
anodised aluminium  
standard bracket

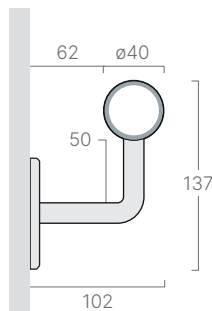

SHR40959  
stainless steel  
bracket

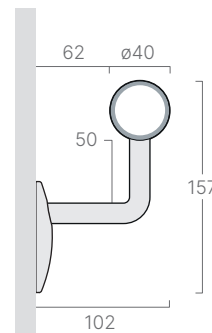

SHR40951  
stainless steel  
bracket with cover

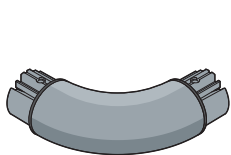

SHR402P  
universal corner

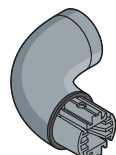

SHR404P  
universal return

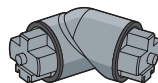

SHR408P  
variable angle



SHR407  
jointing splice



SHR406P  
end stop

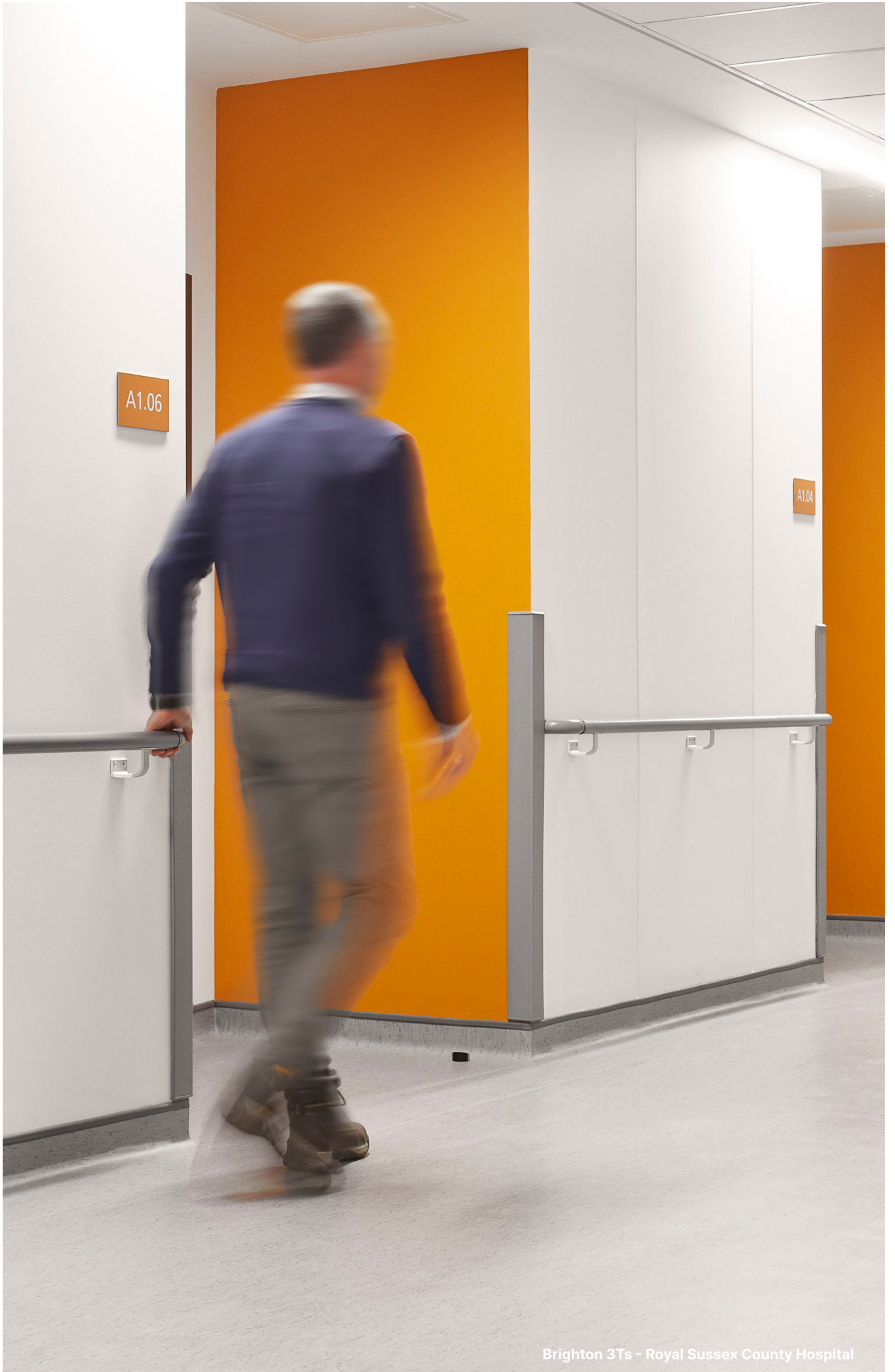

Brighton 3Ts - Royal Sussex County Hospital